

Jinan Meide - Fig 120

Malleable Iron 45 Degree Elbow (Female)

General Specifications

Available Black (Self-Colour) & HDG Galvanised
 Cast Malleable Iron Fittings (Dimensions to BS EN 10242)
 BSPT Taper/Taper Threaded (ISO 7-1)

BSI Kitemarked

Maximum Pressure: 25 bar

Temperature Range: -20°C - 300°C

ISO 9001 Accredited Manufacturer

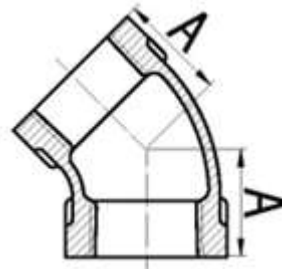

Nominal bore		Length Centre to face dim.A	Weight each
Metric	Imperial	mm	Kgs
6	1/8	16	0.03
8	1/4	18.5	0.05
10	3/8	20	0.08
15	1/2	22	0.08
20	3/4	25	0.13
25	1	28	0.20
32	1 1/4	33	0.33
40	1 1/2	50	0.42
50	2	58	0.66
65	2 1/2	69	1.01
80	3	78	1.47
100	4	96	2.61