

## Art3096 Reduced Bore Mini Brass Ball Valve

### Features

1. Ball valve mini style, reduced bore.
2. Maximum working pressure 16 bar (PN 16).
3. Body brass construction according UNE-EN 12165 chrome plated.
4. Female (BSP) gas threaded ends according ISO 228/1.
5. Working temperature from -20°C to 110°C.
6. Drive by aluminium handle.
7. PTFE Seats.

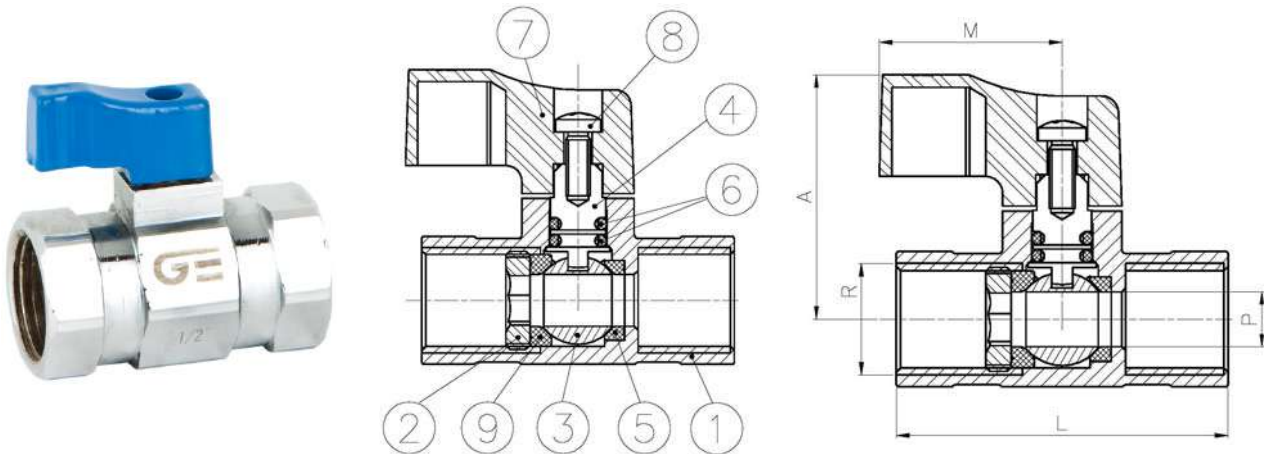

Nº	Name	Material	Surface Treatment
1	Body	Brass	Chrome Plated
2	Cap	Brass	
3	Ball	Brass	Chrome Plated
4	Stem	Brass	
5	Ball Seat	PTFE	
6	O-Ring	NBR	
7	Handle	Aluminium	Painted
8	Screw	Steel AISI 201	
9	Ball Seat	PTFE	

Ref	Size	Dimensions (mm)			Weight (Kg)
		P	A	L	
3096 01	1/8"	6,5	28	37	0,050
3096 02	1/4"	6,5	28	39	0,050
3096 03	3/8"	8	30	42	0,075
3096 04	1/2"	10	33	46	0,105
3096 05	3/4"	12,5	36	55	0,170



### Kv Values

Kv: Water flow rate in cubic meters per hour (m3/h) generating a 1 bar pressure drop across the valve.

Medida / Size	1/8"	1/4"	3/8"	1/2"	3/4"
Kv	2.8	3.5	5	8	13

### Head Loss Chart Threaded Full Bore Ball Valves

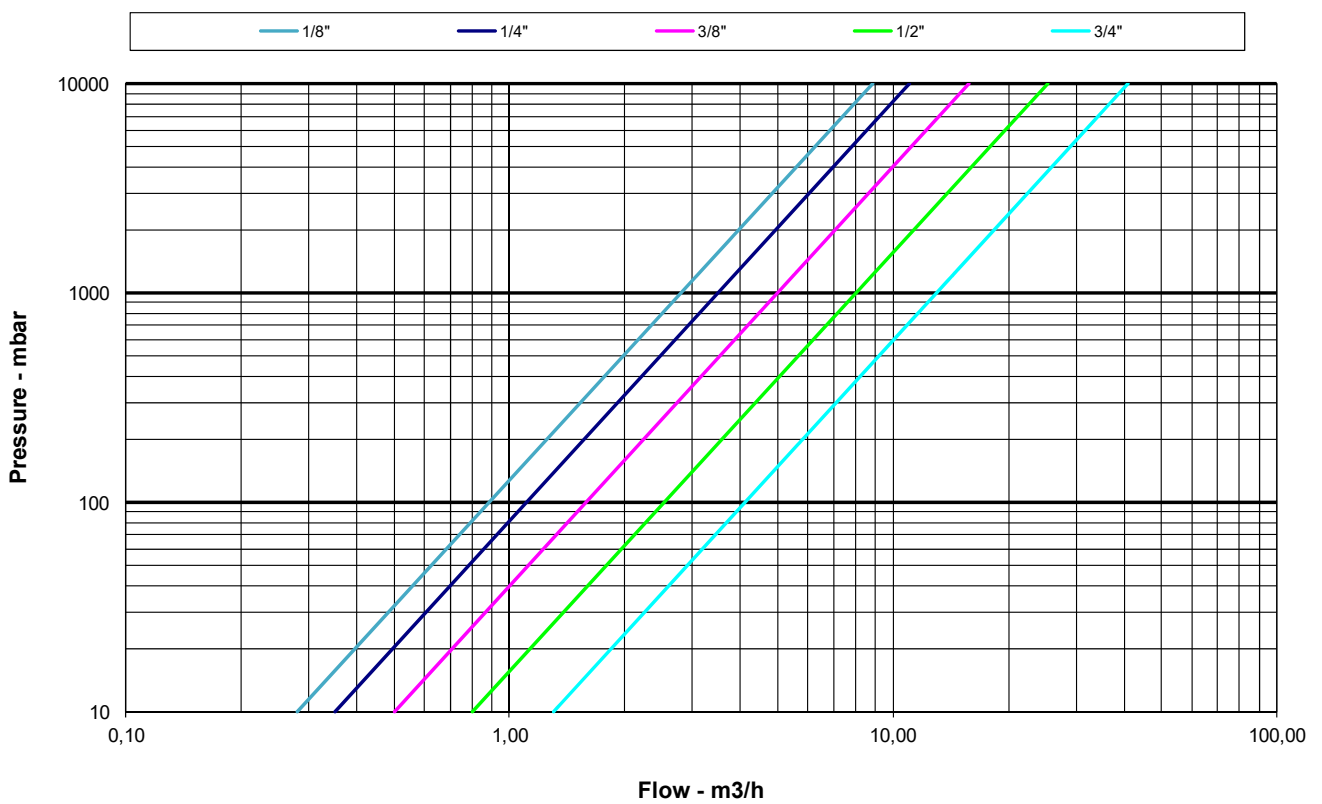



### Pressure/Temperature Rating

