

CSUMF Stainless Steel Male/Female Cone Seat Union (BSP Threaded)

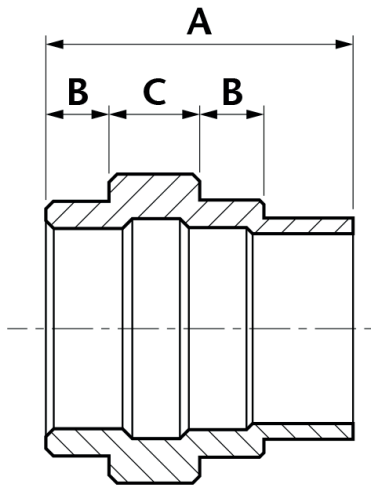

DN	A	B	C	Kgs
1/4"	44.8	10.3	13.5	0.072
3/8"	48.3	11	15	0.123
1/2"	54.8	11.9	16.3	0.159
3/4"	58.8	12.9	17.3	0.234
1"	68.8	15.1	20.3	0.313
1 1/4"	75.5	16.1	22.3	0.541
1 1/2"	79	16.9	24.2	0.615
2"	91	19.2	27.2	1.009



- Made from CF8M (316) Stainless Steel material and conform to **ISO 4144** standard.
- Threads are to ISO 7-1 (DIN2999) BSPP Female, BSPT Male.
- Material certificates available on request.
- Pressure temperature ratings. See table below.

Temperature (°C)	Non-shock maximum working pressure (bar)
-20 to 40	20
100	16.5
150	15
200	14
220	13.5

NOTE 1 Pressure for intermediate temperatures may be determined by the interpolation method.
 NOTE 2 Temperatures indicated are those of internal fluid.
 NOTE 3 Piping loads, stresses and moments are not taken into account.

- Tested & inspected prior to despatch.
- 12 month warranty from date of installation.
- Manufactured in accordance with ISO9001:2015 quality system.