

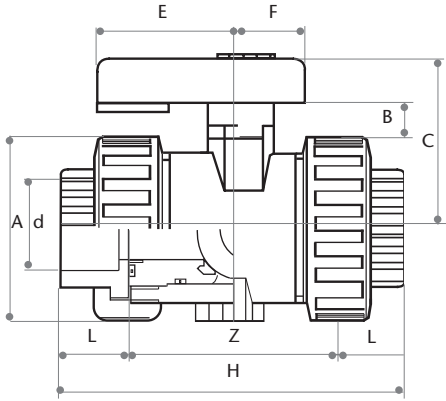

BVI13

Industrial Double Union Ball Valves with plain ends for solvent welding EPDM Seals



d	L	Z	H	A	B	C	E	F	Kg. ABS	Kg. PVC
3/8"	14	62	101	50	10	48	39	19	0.145	0.180
1/2"	16	62	101	50	10	48	39	19	0.135	0.170
3/4"	19	74	120	60	11	54	47	22	0.212	0.265
1"	22	77	130	68	13	62	55	25	0.301	0.370
1 1/4"	26	87	149	80	18	75	60	30	0.436	0.545
1 1/2"	31	93	165	96	20	87	68	35	0.708	0.885
2"	38	113	199	116	20	101	80	40	1.152	1.440
2 1/2"	44	116	217	145	25	123	90	45	1.840	2.300
3"	51	130	250	166	28	138	100	50	2.924	3.650
4"	61	150	292	210	28	160	120	60	4.800	6.000