

BVI10 – Industry ball valve with female ends for solvent welding

U-PVC double union ball valve specific for industrial applications with female ends for solvent welding EN ISO 1452. Adjustable support, possibility of disassembly in both sides in the presence of pressure. Round ball with surface worked by grinding machine. Possibility to fastening and configured for automation by metallic threaded inserts. EPDM seals with double O-R stem, PTFE ball seats. Working pressure PN16 from D.16 up to D.63, PN10 from D.75 up to D.110

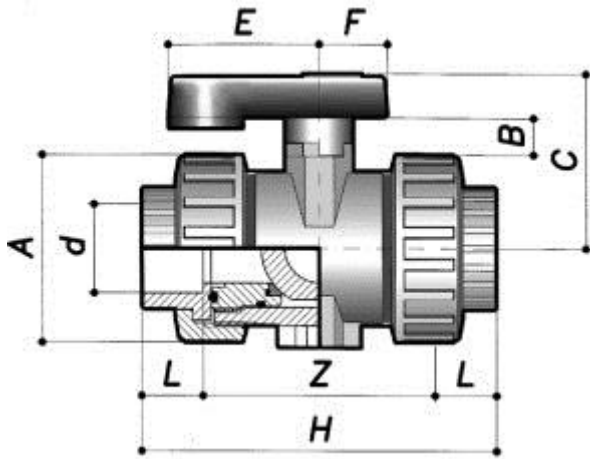

Dimensions

Code	d	DN	L	Z	H	A	B	C	E	F	PN	Gr	Pack	Box
BVI10016	16	10	14	74	102	50	10	48	39	19	16	180	50	M
BVI10020	20	15	16	70	102	50	10	48	39	19	16	170	50	M
BVI10025	25	20	19	82	120	60	11	54	47	22	16	270	32	M
BVI10032	32	25	22	86	130	68	13	62	55	25	16	380	22	M
BVI10040	40	32	26	97	149	80	18	75	60	30	16	570	27	L
BVI10050	50	40	31	103	165	96	20	87	68	35	16	870	18	L
BVI10063	63	50	38	123	199	116	20	101	80	40	16	1500	10	L
BVI10075	75	65	44	130	218	145	25	123	90	45	10	2330	2	M
BVI10090	90	80	51	148	250	166	28	138	100	50	10	3690	2	M
BVI10110	110	100	61	168	290	210	28	160	120	60	10	6040	2	L

Components

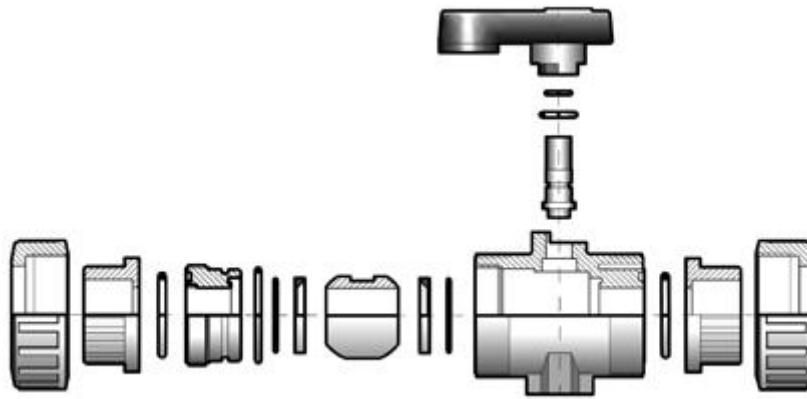

Pos.	Components	N°	Material
1	handle	1	PVC
2	stem	1	PVC
3	body	1	PVC
4	union end	2	PVC
5	union nut	2	PVC
6	ball	1	PVC
7	threaded sealing bush	1	PVC
8	ball seat	2	PTFE
9	union O-ring	2	EPDM
10	O-ring sealing bush	1	EPDM
11	O-ring ball seat	2	EPDM
12	O-ring stem	2	EPDM