

Viking Grooved Tapped Blank (Drilled End Cap)



Approvals



Nominal size		Model	Pipe OD mm (Inch)	Thread Z	Approvals				Weight kg (lbs)
DN	Inch				VdS	LPCB	FM	UL	
50	1	941	60.3 (2.37)	G1" Ecc	G	G	D	D	0.3 (0.7)
65	2-1/2	941	73.0 (2.87)	G1" Ecc	G	G	D	D	0.4 (0.9)
				G1-1/4" Ecc	G	G	D	D	0.4 (0.9)
				G1-1/2" Ecc	G	G	D	D	0.4 (0.9)
				G2" Con	G	G	D	D	0.4 (0.9)
65	3 OD	941	76.1 (3.00)	G1" Ecc	G	G	D	D	0.5 (1.1)
				G1-1/4" Ecc	G	G	D	D	0.4 (0.9)
				G1-1/2" Ecc	G	G	D	D	0.4 (0.9)
				G2" Con	G	G	D	D	0.5 (1.1)
80	3	941	88.9 (3.50)	G1" Ecc	G	G	D	D	0.6 (1.3)
				G1-1/4" Ecc	G	G	D	D	0.5 (1.1)
				G1-1/2" Ecc	G	G	D	D	0.5 (1.1)
				G2" Ecc	G	G	D	D	0.5 (1.1)
100	4	941	114.3 (4.50)	G1" Ecc	G	G	D	D	0.8 (1.8)
				G1-1/4" Ecc	G	G	D	D	0.8 (1.8)
				G1-1/2" Ecc	G	G	D	D	0.8 (1.8)
				G2" Ecc	G	G	D	D	0.7 (1.5)
125	5	941	139.7 (5.50)	G2" Ecc	C	G	D	D	0.9 (2.0)
150	6-1/2 OD	941	165.1 (6.50)	G2" Ecc	C	G	D	D	1.9 (4.2)
150	6	300PX	168.3 (6.630)	G1-1/2" Ecc	-	-	F	E	2.9 (4.6)
		941		G2" Ecc	C	G	D	D	2.1 (4.6)
200	8	300PX	219.1 (8.63)	G1-1/2" Ecc	-	-	D	D	4.1 (9.0)
		941		G2" Ecc	C	G	D	D	4.9 (10.8)
250	10	941	273.0 (10.75)	G2" Ecc	C	G	D	D	7.9 (17.4)

OD = Outside Diameter

Working pressure: A = max. 12.1 bar (175 psi) / B = max. 15.5 bar (225 psi) / C = max. 16 bar (232 psi) / D = max. 20.7 bar (300 psi) / E = max. 25 bar (363 psi) / F = max. 34.5 bar / (500 psi) / G = max. 20 bar (290 psi) / - = no approvals

Technical data

Materialductile cast iron, ASTM A536 Grade 65-45-12

Finish:

- Red paint liquid painting similar RAL 3000
- White powder powder coating similar RAL 9010
- Galvanized hot dip galvanized

Application

Water based fire-suppression systems

Caution

For environments where aggressive, corrosive atmosphere is expected (e.g. direct outdoor exposure, direct contact with water, industrial atmosphere etc.) special surface coatings (e.g. Rilsan, Resicoat etc.) are available.

Installation

Refer to "Grooved Products Installation Guide"

Maintenance

Visual check

Dimensional drawing

Dimensions in mm (inch)

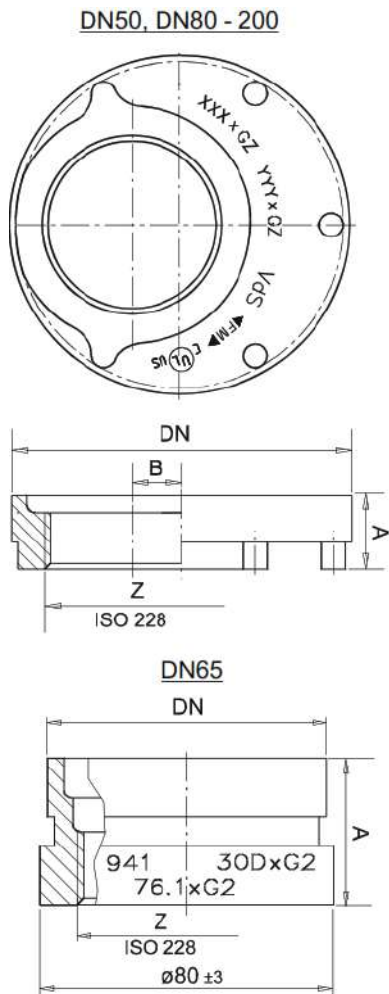

DN / mm	Inch	Thread Z	A (mm / inch)	B (mm / inch)
50 / 60.3	2	G1" Ecc	25 (0.98)	6.6 (0.26)
65 / 73.0	2-1/2	G1" Ecc	40 (1.57)	11.5 (0.45)
		G1-1/4" Ecc		7.0 (0.28)
		G1-1/2" Ecc		4.0 (0.16)
		G2" Con		0
65 / 76.1	3 OD	G1" Ecc	40 (1.57)	13.0 (0.51)
		G1-1/4" Ecc		8.5 (0.33)
		G1-1/2" Ecc		5.5 (0.22)
		G2" Con		0
80 / 88.9	3	G1" Ecc	25 (0.98)	17.0 (0.67)
		G1-1/4" Ecc		12.5 (0.49)
		G1-1/2" Ecc		9.5 (0.37)
		G2" Ecc		3.5 (0.14)
100 / 114.3	4	G1" Ecc	25 (0.98)	30.0 (1.18)
		G1-1/4" Ecc		25.5 (1.00)
		G1-1/2" Ecc		22.5 (0.89)
		G2" Ecc		16.0 (0.63)
125 / 139.7	5-1/2 OD	G2" Ecc	25 (0.98)	28.7 (1.13)
150 / 165.1	6-1/2 OD	G2" Ecc	25 (0.98)	41.5 (1.63)
150 / 168.3	6	G1-1/4" Ecc	25.4 (1.00)	-
		G2" Ecc	25 (0.98)	43.0 (1.69)
200 / 219.1	8	G1-1/2" Ecc	30.2 (1.19)	-
		G2" Ecc	31 (1.22)	68.2 (2.69)
250 / 273.0	10	G2" Ecc	32 (1.26)	95.0 (3.74)